

CERTIFIED RECORD OF LAND CORNER MONUMENTATION

V-15

History of original corner establishment:

Original corner established in 1881 by Rabb & Graden.
 Set stone 10x10x8 from which:
 A 24" pine brs. N55°E 96 lrs.
 A 12" pine brs. S45°E 48 lrs.

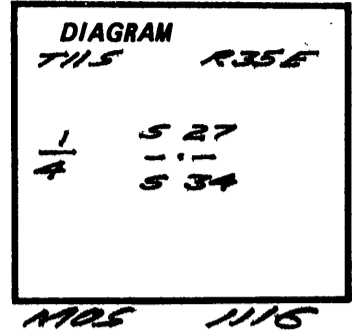

Description of corner evidence found: Searched for not found, corner position falls in old railroad bed.

22" PP with scribes brs. S40°E 31.7'
 Pine snag with scribes brs. N50°E 63.4'

Description of monument and accessories I established to perpetuate the original location of this corner: Set 2 1/4" x 30" aluminum pipe with 2 1/2" aluminum cap rising 10" in stone mound.

New BT:
 A 7" PP brs. North 39.2'
 marked 14527 BT

Cap marked

T115 R35E

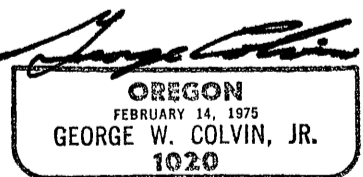
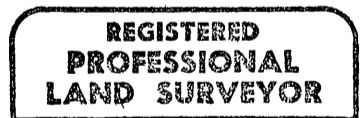
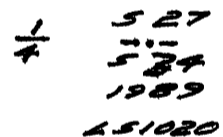

I hereby certify the above corner was perpetuated as described on July, 1989.

Office of County Surveyor County of Grant
 State of Oregon, I hereby certify that the within instrument was filed in this office for record on the 14 day of July, 1989
Robert D. Bayliff by _____
 (COUNTY OFFICIAL) (DEPUTY)